

## Connect to WLAN-SMU Wireless for iOS

### >>> Self-help Guide <<<

#### Connect to WLAN-SMU Wireless

#### On iOS Devices (iPhone, iPad)

Reference OS: iOS 8.3

1. Open the **Settings** application, tap **Wi-Fi** and choose **WLAN-SMU**.

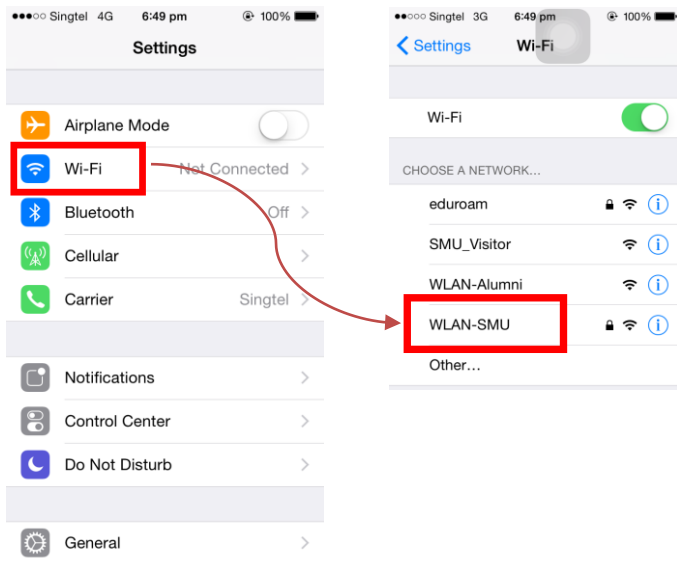

2. You will be asked to enter a Username and Password. Use your SMU User ID and password.

*Example:*

- > Faculty/Staff: emilyho
- > Student: emily.ho.2014

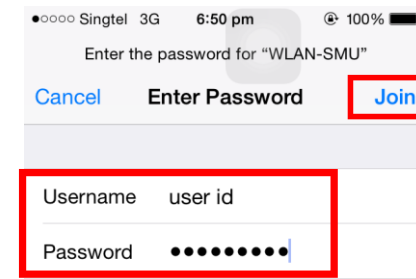

3. After entered above information, tap the **Join** button.
4. On the certificate page, tap the **Accept** button.

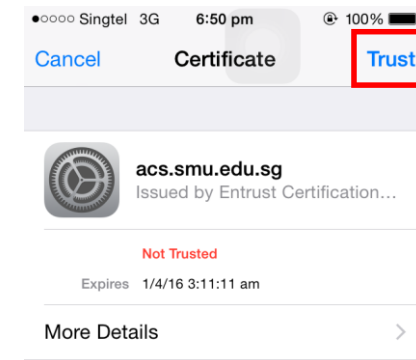

5. Your iOS device is now connected to WLAN-SMU.