

Configure SMU Wi-Fi (WLAN-SMU) : Non-Joined Domain

>>> Self-help Guide <<<

Configure SMU Wi-Fi (WLAN-SMU) – Non Joined Domain

Reference OS: Windows 10

1. Press **Windows**  + **R** to open the Run dialog, enter **control panel** in the empty box and click **OK**.

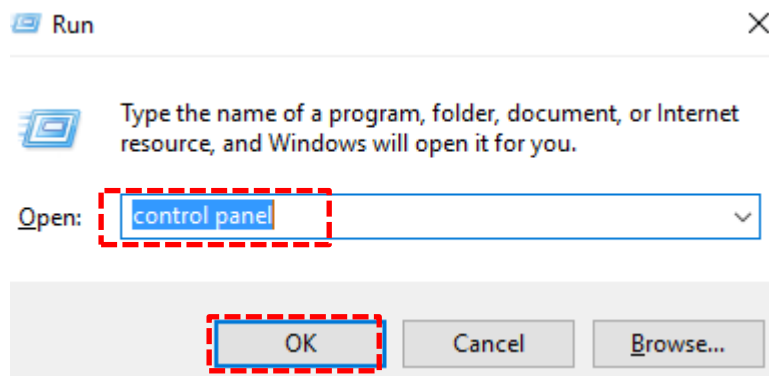

2. In the Control Panel window, click on “**Network and Internet**”.

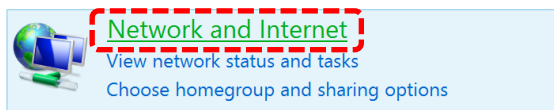

3. In the Network and Internet windows, click on “**Network and Sharing Center**”.

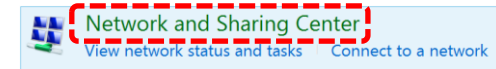

4. In Network and Sharing Center windows, click on “**Set up a new connection or network**”.

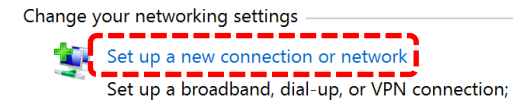

5. Next, click on “**Manually connect to a wireless network**”.



6. When prompted to enter the wireless network information:
 - Enter the Network name/SSID:
WLAN-SMU
 - Select “**WPA2-Enterprise**” as the Security Type. Encryption type will be defaulted to **AES**.
 - Enable the “**Start this connection automatically**” check box.
 - Enable the “**Connect even if the network is not broadcasting**” checkbox.

Configure SMU Wi-Fi (WLAN-SMU) : Non-Joined Domain

- Click “Next” button.

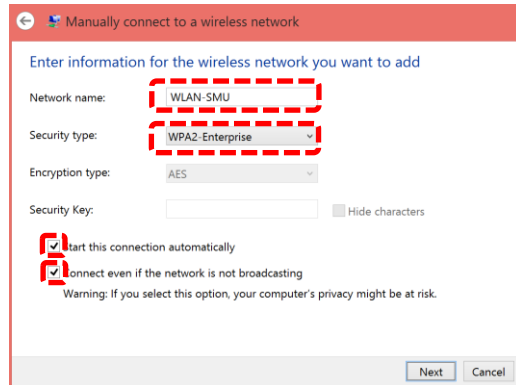

- In the next window, click on “Change connection settings”.

Successfully added WLAN-SMU

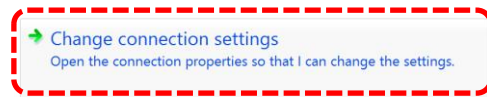

- In the pop-up window, **Wireless Network Properties**:
 - Click on the “Security” tab.

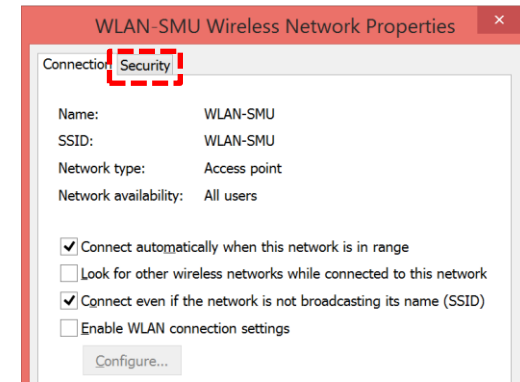

- Under the **Security** options:

- Click on the “Settings” button.

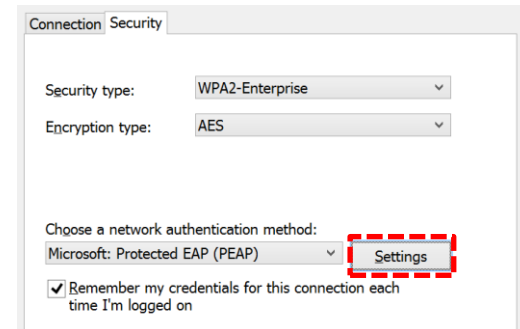

- In the Protected EAP Properties page:

- Select the following **Settings**:

Configure SMU Wi-Fi (WLAN-SMU) : Non-Joined Domain

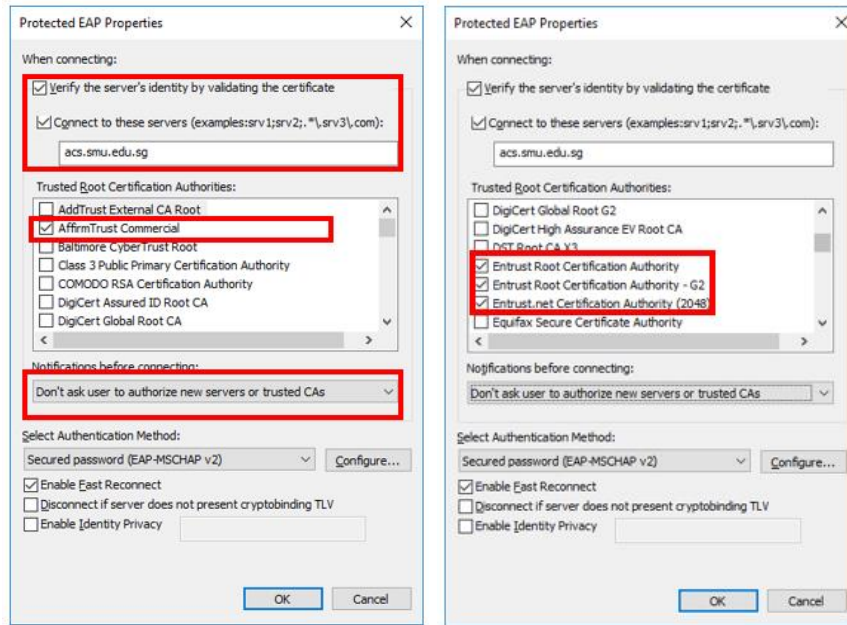

- Ensure the checkbox for **“Automatically use my Windows login name and password”** is checked and click on **OK** button.



11. Under the **Security** options:

- Click on the **“Advanced settings”**.

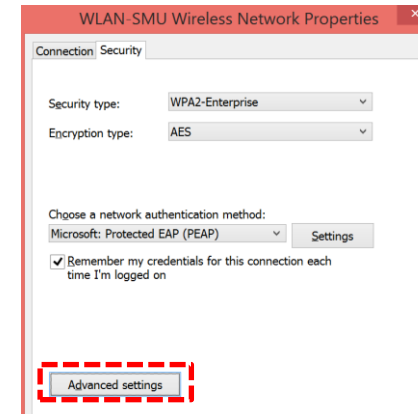

- Click on the **“Configure...”** button.

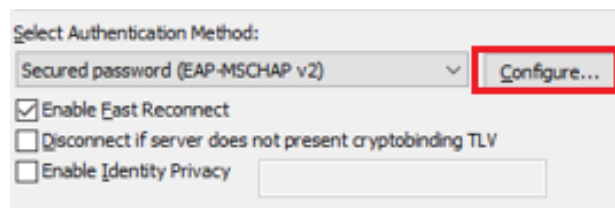

Configure SMU Wi-Fi (WLAN-SMU) : Non-Joined Domain

- Ensure the checkbox for “**Specify authentication mode:**” is checked.
- From dropdown menu, select “**User authentication**”.

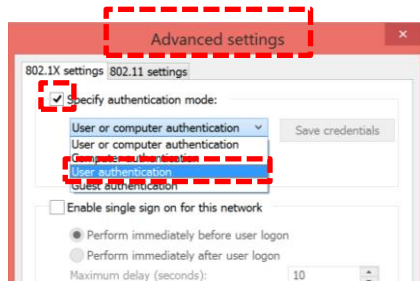

12. Click on the wireless connection icon as shown in the diagram to view the status of the wireless access.



13. When you are within range of the Wireless Access Point and your wireless network radio enabled, Windows will display a “**Connected**” message.

- Click on the “**Save credentials**” button.

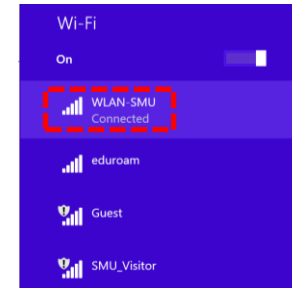
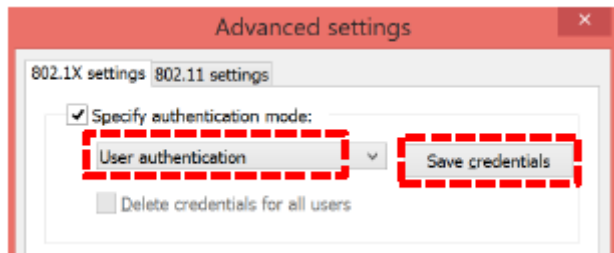

- Enter your SMU username and password and click on “**OK**” button.

